

STANDOFF= 0.200" to 0.100"

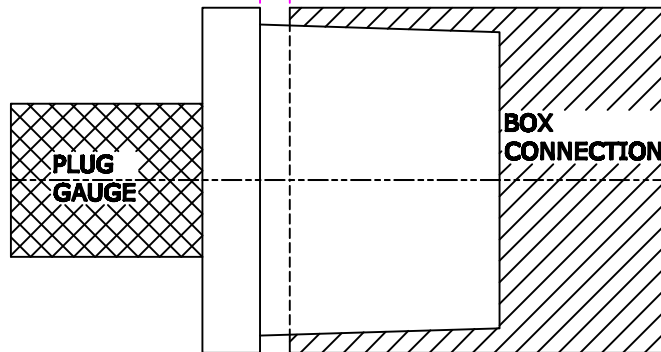

TYPE	STANDOFF TOLERANCE
PLUG GAUGE	+0 -1/2P
RING GAUGE	+1/2P - 0

(FLUSH) 0 to 0.100"

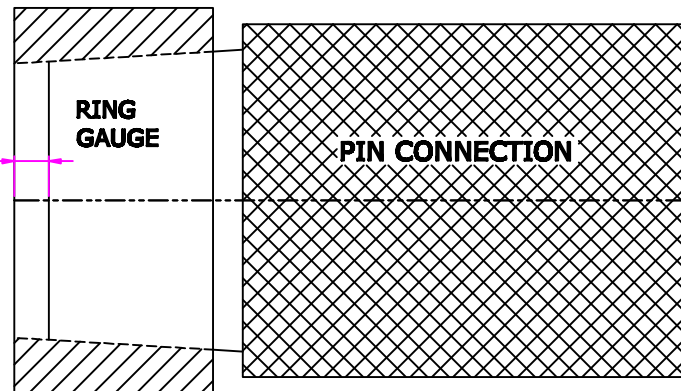

$$TPF = \frac{3}{4}$$

$$P=PITCH= 5 \text{ TPI } (0.200")$$

NOTE : ALL DIMENSIONS ARE IN INCHES

**NORTHERN GAUGE INC.  
CANADA.**

**5" - 13  $\frac{3}{8}$ " BUTTRESS CASING  
STANDOFF AGAINST END OF PIPE**

**REVISED DATE : 28 JUNE 2014**

**PREPARED BY:  
SAYYED TABISH**

**APPROVED BY:  
KHELE R.A.**