

STANDOFF= 0.100" to 0.000"

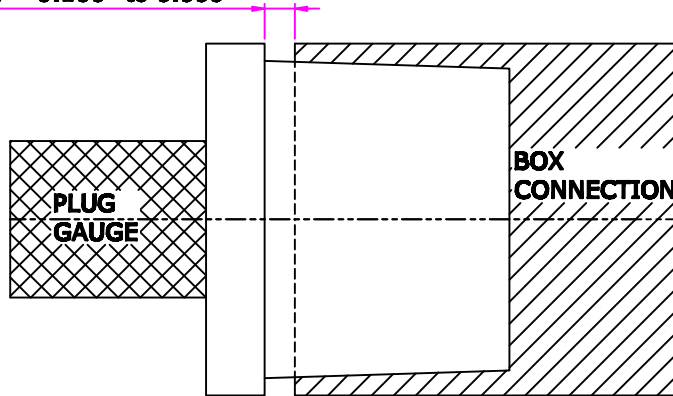

TYPE	STANDOFF TOLERANCE
PLUG GAUGE	+0 -1/2P
RING GAUGE	+1/2P - 0

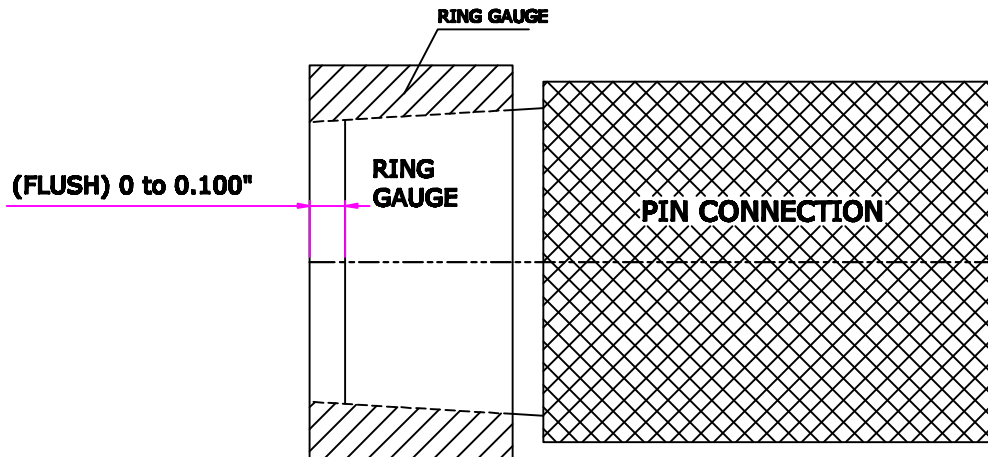

$$TPF = \frac{3}{4}''$$

$$P=PITCH= 5 \text{ TPI } (0.200'')$$

NOTE : ALL DIMENSIONS ARE IN INCHES

**NORTHERN GAUGE INC.
CANADA.**

**4-1/2" BUTTRESS CASING
STANDOFF AGAINST END OF PIPE**

REVISED DATE : 28 JUNE 2014

**PREPARED BY:
SAYYED TABISH**

**APPROVED BY:
KHELE R.A.**